



Lot & Land Customer Financial Report w/Photos
Lot & Land Customer Financial Report



General Information

List Price: \$3,750,000
MLS#: 226011543
Address: 10200 METRO PKWY
 FORT MYERS, FL 33966
GEO Area: FM07 - Fort Myers Area
County: Lee
Property ID: 06-45-25-P1-00063.0020
Lot: 2
Lot Type: Commercial Lot
Block/Bldg: 63
Parcels:
Zoning: CI
Legal Unit: 1
Potential Short Sale: No
Virtual Tour URL:
Land Use Code: 10-Vacant Commercial
Other PIDs:

ML# 226011543

Status: Active (02/13/26)
Trans Type: Sale

Property Class: Lot and Land
Subdivision: NOT APPLICABLE
Development: NOT APPLICABLE

Sec/Town/Rng: 06/45/25E
Foreclosed REO: No

Detailed Property Information

Property Information: Costco closed on 55 acre across the road for \$55m at \$1m/acre or \$33/sf on May 12, 2026. 5+acre on Metro Pkwy, 1/4 mile south of Colonial Blvd, across from to be built Costco. CI (Commercial Intensive, City of Fort Myers) zoning is suitable for a variety of commercial uses including but not limited to self-storage, car dealership, auto repair, gas station, car wash, hotel, motel, inn, extended stay facility, warehousing or distribution center, as well as 40 units/acre multifamily or 40 residential units/acre, subject to Port Authority restrictions. This area is experiencing explosive residential and commercial growth with many single-family and apartment developments just moments away. High retail concentration area with a mix of top national brands offering shopping, dining and entertainment venues. ML# 226011543

Approx. Lot Size: 322x913x175x900
Lot Size: 5.23 (acres) / 227,732 (sqft)
Approx Sqft.Land:
Rear Exposure: W
Elevation:
Lot Desc.: See Remarks
Restrictions: None/Other
Utilities: Electric, Other
Usage: Commercial
Road: City Maintained, Paved Road, Public Road
Sewer: Central
Water: Central
Subdivision Info:

Gas YN:
Gas Description:
Trees:
Ground Cover:
Land:
Avail. Documents:
View: None/Other
Dock:
Boat/Dock Info:
Waterfront: No
Waterfront Desc.: None
Gulf Access: No
Canal Width: None

Financial/Transaction Information

Total Tax Bill: \$13
Tax Year: 2025
Tax Desc: City And County
HOA Fee:
HOA Description:
Master HOA Fee:
Condo Fee:
Transfer Fee: \$0

Spec Assessment:
Land Lease:
Mandatory Club Fee:
Rec. Lease Fee: \$0

One Time Fees
Spec Assessment:
Land Lease:
Mandatory Club Fee:
Rec. Lease Fee: \$0
Other Fee: \$0

Approval:
Terms: Buyer Finance/Cash
Maintenance: None
Possession: At Closing
Special Info:
Property Location: Not Applicable
Legal Desc: FR NW COR SEC E1679FT TH S1025FT TH W50FT TO POB TH W900FT S175FT E913FT N330
Listing Broker: NRT Commercial LLC

ML# 226011543



Map / location

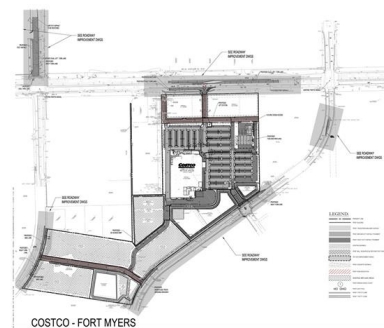

Costco Site Plan

Video and/or audio surveillance with recording capability may be in use on these premises. Conversations should not be considered private.

The source of the foregoing property information is a database compilation of an organization that is a member of the Southwest Florida Multiple Listing Service. Each Southwest Florida Multiple Listing Service member organization owns the copyright rights in its respective proprietary database compilation, and reserves all such rights. Copyright © 2026. The foregoing information including, but not limited to, any information about the size or area of lots, structures, or living space, such as room dimensions, square footage calculations, or acreage is believed to be accurate, but is not warranted or guaranteed. This information should be independently verified before any person enters into a transaction based upon it.